

## Android Configuration/Setup for UNC Health Care

Select Settings

Select Add Account

Select type: Corporate Email

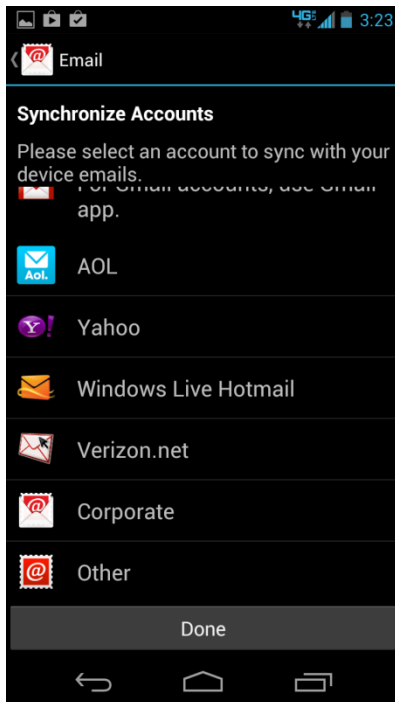

Type email address (i.e. bob.test@unchealth.unc.edu)

Type login password

Next

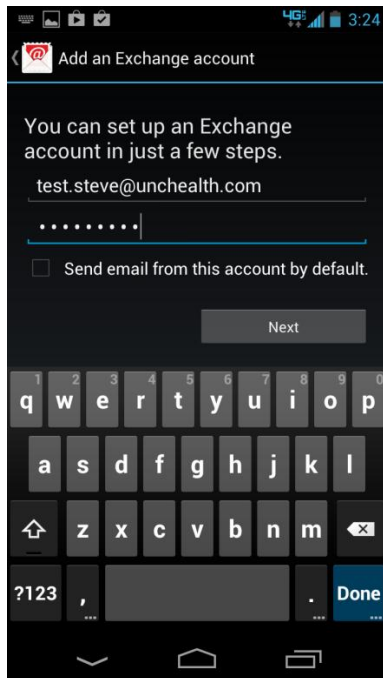

### **Account Setup**

Domain\Username: unch\your login name (i.e. unch\stest)

Password (pre-filled from previous screen)

Server name: caoma.unch.unc.edu

Use secure connection (should be checked)

Press Next

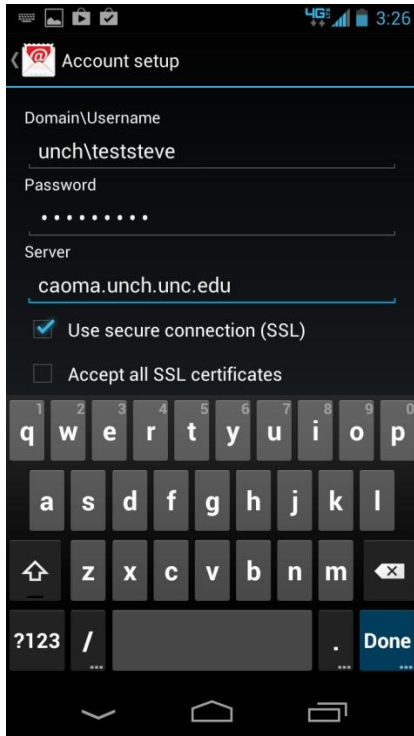

Options/Preferences – select

Done

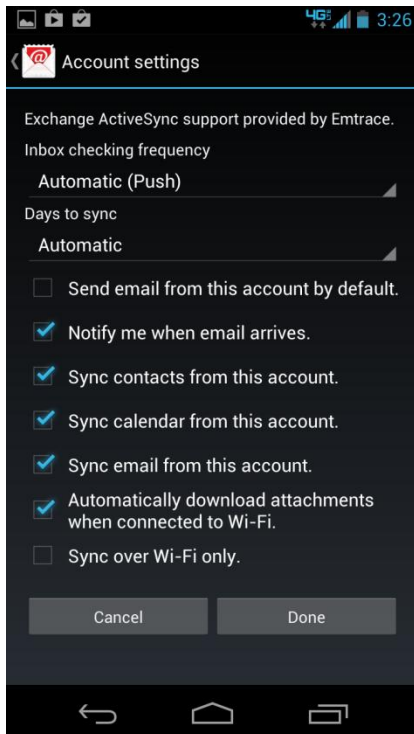

Name the email account (Steve Test) or your preference

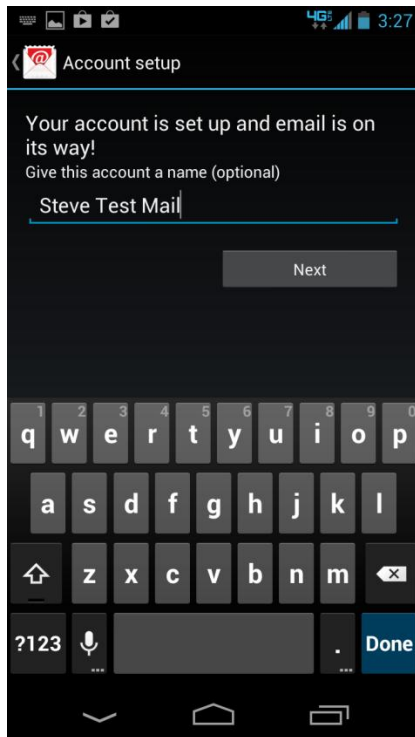

Next

Your account configuration has been completed.